

INDUSTRIAL WASHER EXTRACTOR

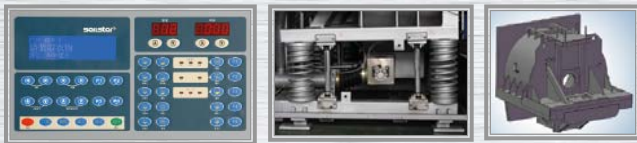

MODELS AVAILABLE

MSM30 MSM100

MSM50 MSM150

MSM70

ROBUST INDUSTRIAL STRENGTH

The robust long lasting structural proven by Finite Element Analysis is supported by 4 industrial strength springs and multiple shock absorbers provide excellent suspension minimize the wasted time and energy due to unbalance during daily operation.

ADVANCED CONTROL SUITS ALL LAUNDRY

Standard computer with 30 fully programmable wash formulas allows any user to set the water level, temperature, rotation speed, cool down, 10 dosing signals, etc...freely in individual steps according to actual needs of any kind of customers. All programs can be easily transferred to multiple machines by connecting to laptop thru a USB cable. The separate I/O board with indicator LED in the electrical cabinet for easy trouble shooting.

MANUAL OVERRIDE CONTROL

Equipped with separate manual override control switches to run the machine in case of emergency. No down time due to unexpected computer failure.

WATER REUSE CONNECTIVITY

Optional reuse water inlet and reuse drain for connecting to external water reuse system. Small investment to save up to 40% water consumption.

STEAMLESS ELECTRIC HEATING

Electrical heating version is available on MSM30, MSM50 and MSM70 for those without steam facility.

FREE STANDING HIGH SPEED

The machine is designed for 300 G-force high extract accepted by most laundry worldwide remove more moisture than other low or medium spin machines after extract, reducing the time and energy for drying or ironing while protecting the fabrics.

FREQUENCY INVERTER DRIVE

Frequency inverter drive allows programmable variable wash speed to suits wide variety of fabrics. Single motor mounted on top of machine away from moisture and heat of drain pit underneath proven last longer than motor at the bottom.

PERFECT CLEANING QUALITY

Large diameter basket with multiple ribs produces better mechanical wash action for optimum wash quality with less detergent. 5 automatic detergent cups turn over and flush all required detergents thoroughly into the basket at right preset timing, no remaining lump wasted in cups. Wash faster even for heavy soiled linens.

TECHNICAL SPECIFICATIONS

	MSM30	MSM50	MSM70	MSM100	MSM150
Rated Capacity	30kg	50kg	70kg	100kg	150kg
Basket Volume	320L	515L	713L	1015L	1540L
Basket Diameter	902mm	1067mm	1240mm	1240mm	1460mm
Basket Depth	500mm	576mm	590mm	840mm	920mm
Door Opening Diameter	467mm	513mm	632mm	632mm	739mm
Motor	4kw	5.5kw	7.5kw	11kw	22kw
Inverter	5.5kw	7.5kw	11kw	15kw	22kw
High Extract G-Force	300G	300G	300G	300G	300G
Water Consumption	745L/h	1090L/h	1280L/h	1530L/h	2175L/h
Steam Consumption	26kg/h	42kg/h	60kg/h	78kg/h	106kg/h
Air Consumption	10L/h	10L/h	10L/h	10L/h </td <td>10L/h</td>	10L/h
Electric Consumption	0.82Kwh	1.12Kwh	1.38Kwh	1.42Kwh	3.96Kwh
Net Weight	1910kg	2660kg	2860kg	3230kg	5000kg

* Consumption may vary depends on actual condition

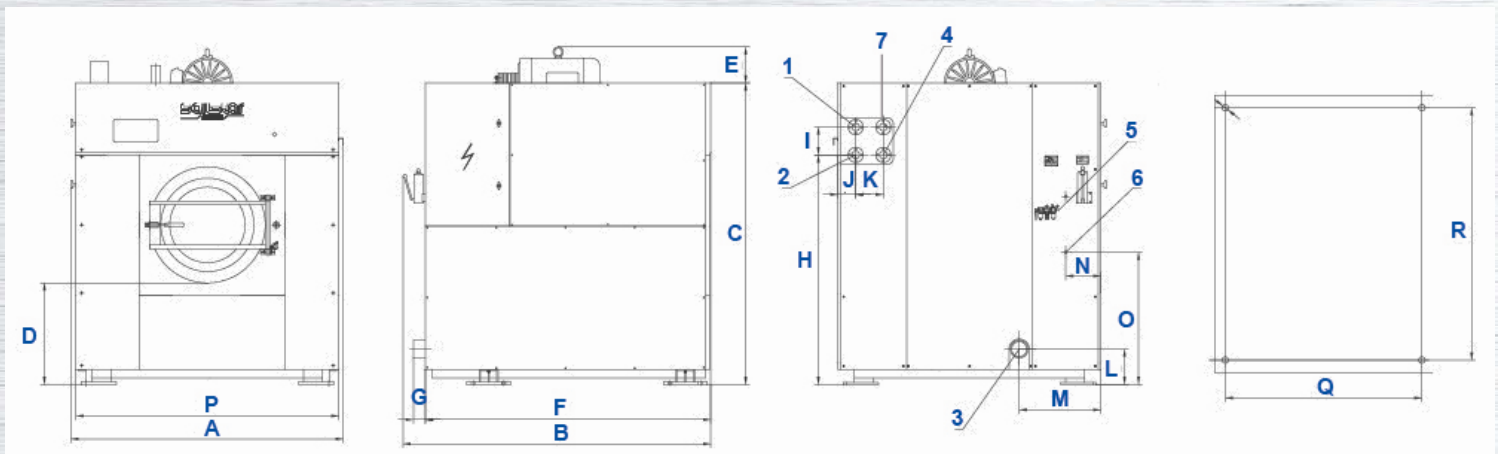

DIMENSIONS

	A	B	C	D	E	F	G	H	I	J	K	L	M	N	O	P	Q	R	S
MSM30	1483	1598	1765	610	195	1420	95	1225	250	130	210	291	453	170	665	1400	1240	562	20
MSM50	1710	1801	1910	718	170	1620	95	1385	250	130	210	275	560	120	1010	1640	1445	1278	20
MSM70	1820	1908	2090	740	250	1730	95	1540	250	130	210	250	620	120	940	1750	1550	927	20
MSM100	1820	2083	2090	740	250	1905	95	1540	250	130	210	250	620	120	940	1750	1550	1089	20
MSM150	2168	2448	2390	805	450	2270	95	1820	250	140	220	280	650	150	1290	2090	1930	1804	30

CONNECTIONS

	1	2	3	4	5	6	7	8
	Cold water	Hot Water	Drain	Steam	Compress Air	Electrical Cable	Reuse Water	Reuse Drain
MSM30	DN25	DN25	150mm	DN20	8mm	25mm	DN25	150mm
MSM50	DN40	DN40	150mm	DN25	8mm	25mm	DN40	150mm
MSM70	DN40	DN40	150mm	DN25	8mm	25mm	DN40	150mm
MSM100	DN40	DN40	150mm	DN25	8mm	25mm	DN40	150mm
MSM150	DN50	DN50	150mm	DN40	8mm	25mm	DN50	150mm

* Reuse water inlet and reuse drain is optional

CE certification not applicable to electric heating machines

We reserve the rights to change the specifications without prior notice

Shanghai Sailstar Machinery Group Co. Ltd.
1 Fengpu Avenue, Fengpu Industrial Zone,
201400 Shanghai, P.R. China

Tel: 86-21-67100168
Fax: 86-21-67100167
Email: info@sailstar.com.cn
Website: www.sailstar.com.cn